

## **Burnished Velvet™ Dark Colored Background Process**

*Technique Created By Haroldine Wingfield and Deanna Pannell*

\*This Tutorial is not to be reproduced without permission

### **Supply List:**

- Glitter Ritz™ Black, Glitter Ritz™ Liberty Blue, Glitter Ritz™ Kiwi Green and Glitter Ritz™ Stardust Microfine glitters
- Be Creative® 40MM Tape
- Be Creative® Fine Point Tweezers
- Be Creative® Precision Blade
- Be Creative® Glitter Magnet
- Punch Bunch flower and fern punches, McGill 1/8 and 3/16 circle punches (for flower centers)

### **Part A – Burnished Velvet Technique**

**Step 1:** Cut Splash cardstock (Bazzill) to 5.5 x 8.5 inches. Score at 4.25 inches and fold the card.

**Step 2:** Lay 40 MM Be Creative tape on the card front ¼ inch from the fold. Peel off backing and apply negative masks (the punched pieces) to exposed tape backing with Be Creative Tweezers. Press the punched shapes to the tape firmly using a piece of backing to protect the exposed tape. Apply Black Microfine Glitter to the tape. Brush off excess glitter. **Burnish** with your fingertip by rubbing the glittered area firmly.



**Step 3:** Remove the small flower masks using Tweezers and apply Liberty Blue Microfine Glitter. Brush off excess and **burnish** as in Step 1.

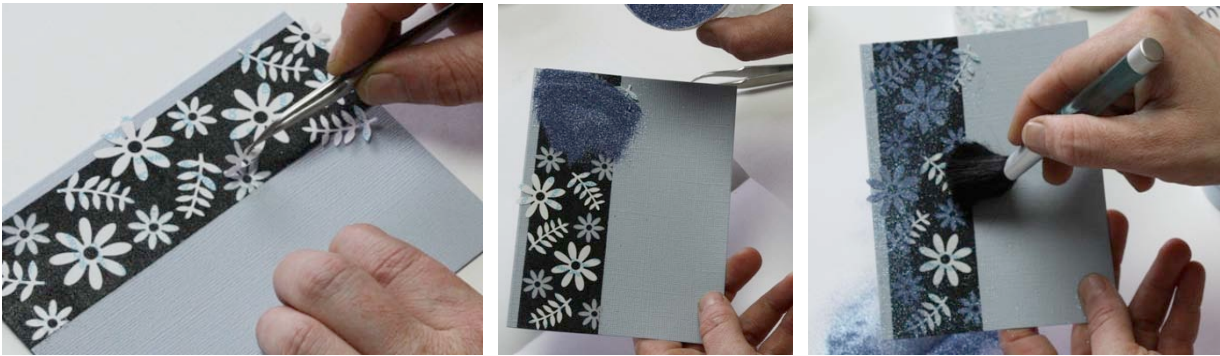

**Step 4:** Remove the fern masks using Be Creative Tweezers and apply Kiwi Green Microfine Glitter to the remaining area. Brush off excess and **burnish**.

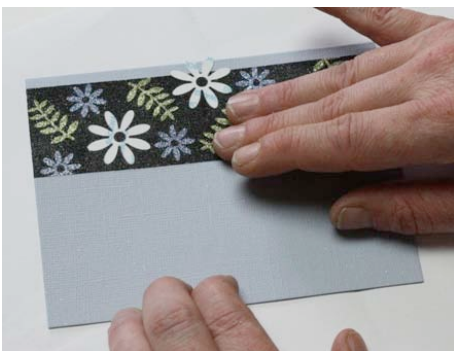

**Step 5:** Remove the large flower masks using Be Creative Tweezers and apply Stardust Microfine Glitter to the remaining area. Brush off excess and **burnish**.



**Step 6:** Use Be Creative Glitter Magnet to clean excess glitter from your workspace. Note: Do not use Glitter Magnet on masks or paper.



### **Part B – Scored Lattice Technique**

**Step 1:** Open the card and place it on the Scor-It-All as shown. Score a line 2 inches from the folded edge or  $\frac{1}{4}$  from the bottom of the Burnished Velvet piece. Move the card to the left and score  $\frac{1}{4}$  from the bottom of the card.

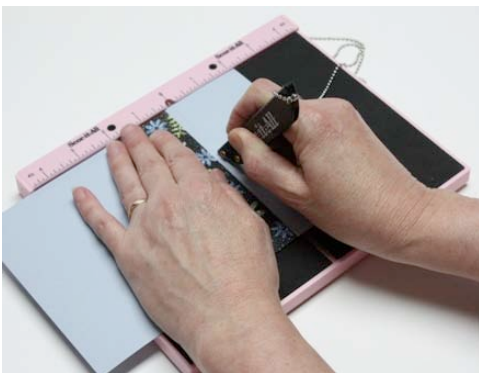

**Step 2:** Turn the card  $\frac{1}{4}$ . Score  $\frac{1}{4}$  inch in from each side edge of the card.

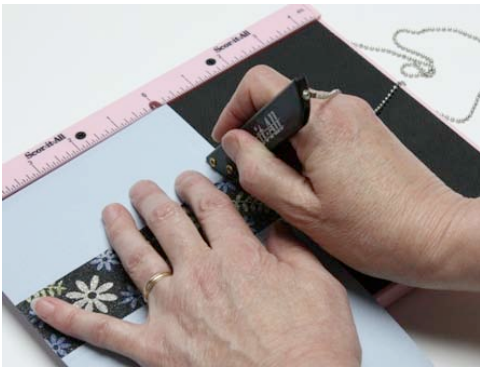

**Step 3:** Turn the card lengthwise again and score  $\frac{1}{4}$  inch inward from the last score line.

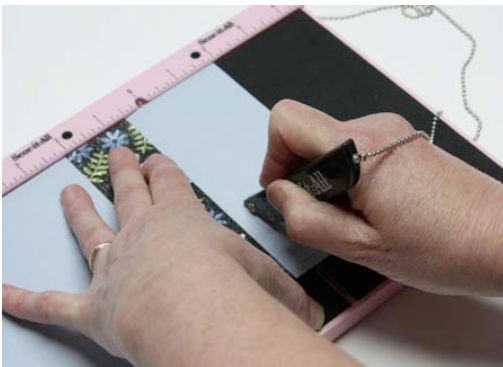

**Step 4:** Move the card to the left again and score  $\frac{1}{4}$  inch inward from the bottom score line.



**Step 5:** Turn the card lengthwise again and score  $\frac{1}{4}$  inch inward from the last score line.



**Step 6:** Score the 3<sup>rd</sup> and final line  $\frac{1}{4}$  inch from the bottom of the Burnished Velvet section.

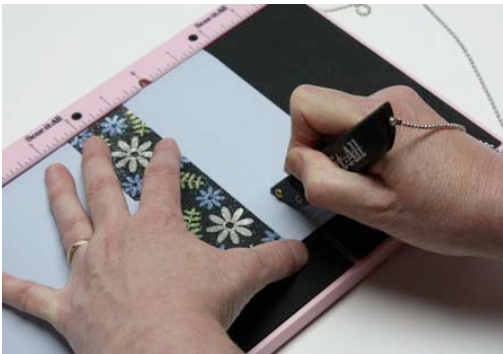

**Step 7:** Apply Thanks Black Peel-Off Sticker to the center of the scored frame.



**Mailing Tip:** Place card inside plastic sleeve before the paper envelope to ensure your card arrives in perfect condition. The humidity in differing climates can affect the adhesive slightly.